

- 500MP @40 fps
- Built-in high-precision positioning, measurement and identification algorithms
- Output results via RS-232 and Ethernet, and cooperate with other processes via I/O
- Optional multi-focal length lens
- Uniform brightness of illuminated areas



Applied range • Counting • Existence • Size Measuring • QR Code Reading • Logistics Industry • Food and Medical Industry

Vision Tool

- Count: Spot count, edge count, pattern count, contour count
- Defect detection: Exception detection
- Existence: Circle existence, line existence, spot existence, edge existence, pattern existence, contour existence
- Location: Match calibration, match location, position fixture
- Logic tool: If module, condition judge, logic judge, combination judge, string comparison, calculator
- Measurement: L2L angle, diameter measurement, brightness analysis, contrast measurement, width measurement, P2L measurement, greyscale size, line angle, edge width measurement
- Recognition: OCR, code recognition, classification registration, object detection registration
- Deep learning: DL object detection, DL classification

Model	VT-SM2-2432DL-M/C08	VT-SM2-2432DL-M/C12	VT-SM2-2432DL-M/C16
Solution capacity	Supports importing and exporting project, up to 32 projects can be stored.		
Communication protocol	RS-232、TCP、UDP、FTP、Modbus、MELSEC/SLMP、FINS、Keyence KV		
Resolution [H*V]	2432 × 2048		
Sensor size	1/1.45"		
Sensor type	CMOS, global shutter		
Pixel size	3.45μm × 3.45μm		
Lens mount	M12-mount, mechanical autofocus supported		
Focal length	8mm	12mm	16mm
Lens cap	Polarized + diffused + full-transparent lens cap		
Light source	White spot light source. Red/blue/IR point light source is optional		
Aiming system	Orange LED		
Indicator	360° visual indicator		
Max. frame rate	40 fps		
Exposure time	6 μs ~1 sec		
Dynamic range	77.8 dB		
SNR	43 dB		
Gain	0 ~ 15 dB		
Color	Mono/Color		
Pixel format	RGB 8, Mono 8		
Data interface	Fast Ethernet (100Mbit/s)		
Digital I/O	Supports triggering device via pressing top trigger button 12-pin M12 connector provides power and I/O, including opto-isolated input (LINE 0/1/2) × 3, opto-isolated output (LINE 3/4/5) × 3, and RS-232 × 1		
Power supply	24 VDC		
Power consumption	6.5 W@24 VDC		
Dimension/Weight	Straight angle: 80.1 mm × 43 mm × 44.3 mm Right angle: 58.5 mm × 43 mm × 65.4 mm(190g)		
Temperature/Ingress protection	-30~70 ° C (Storage temperature), 0~50° C (Working temperature) IP67 (under proper installation of waterproof lens cap)		
Software	SM-Datum		

Dimensions:

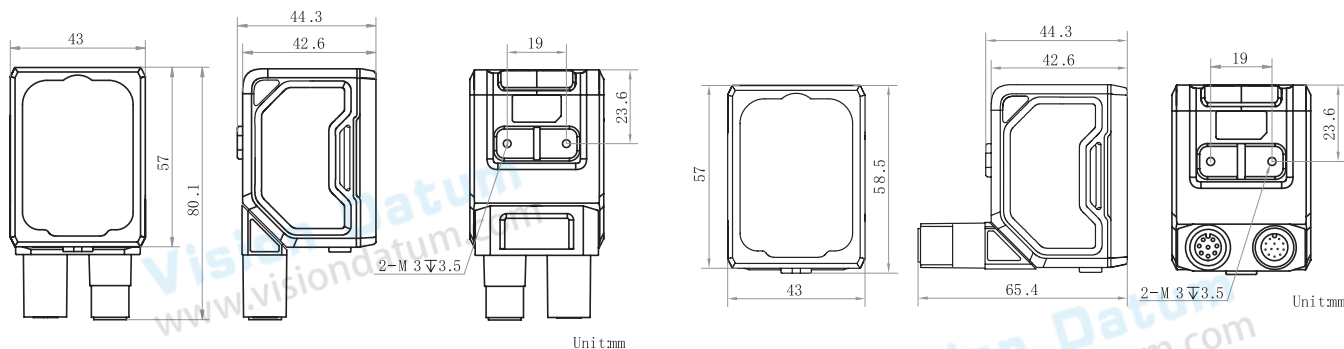

Detection Range:

Lens focal length (mm)	Working Distance (mm)	Field of view (mm)	Single pixel accuracy
8 mm	25 mm	26.22mm × 22.08 mm	0.011 mm
	2000 mm	2097.6 mm × 1766.4 mm	0.863 mm
12 mm	60 mm	41.95 mm × 35.33 mm	0.017 mm
	2000 mm	1398.4 mm × 1177.6 mm	0.575 mm
16 mm	100 mm	52.44 mm × 44.16 mm	0.022 mm
	2000 mm	1048.8 mm × 883.2 mm	0.431 mm



Vertical FOV/mm

